



PUFFCO

PIVOT

WHAT'S INSIDE [01]

HOW TO USE [02-04]

HEAT SETTINGS [05]

CLEANING [06]

TIPS & TRICKS [07]

TROUBLESHOOTING [08]

What's Inside

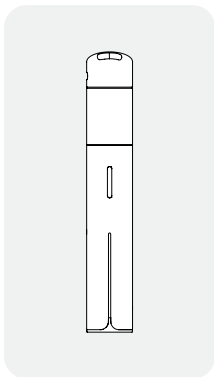

Features



Quick-Release
3D Chamber



Real-Time
Temp Control



Light Bar +
Dab Timer

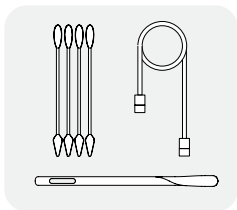

What's Inside

- Pivot 3D Chamber + Mouthpiece
- Pivot Base
- USB-C Cable
- Cotton Swabs
- Loading Tool

How To Use

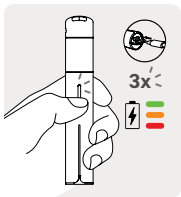

Fully charge device before first use. The light bar will glow indicating the battery level.

Green (Full)
Orange (Half)
Red (Low)

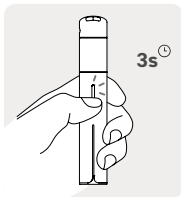

To turn the Pivot on/off, hold down the button for 3 seconds.

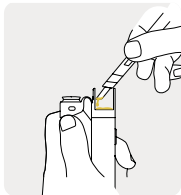

Flip open the mouthpiece and use the loading tool to place hash on the bottom surface of the 3D Chamber.

How To Use

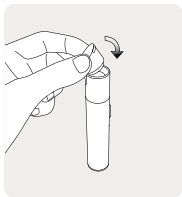

Replace the mouthpiece on top of 3D Chamber and press down until snug.

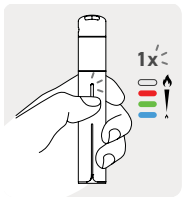

Single-click button to toggle through each heat setting.

White (Peak)

Red (High)

Green (Med)

Blue (Low)

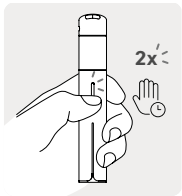

Double-click to initiate heat cycle, press & hold to cancel. Light bar will fill to indicate heat up.

How To Use



Device will flash & vibrate twice when ready. Hold upright and inhale gently. Light bar will empty slowly to indicate dab time remaining.

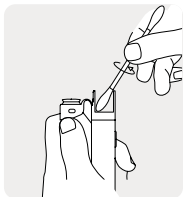

Clean 3D Chamber after each use with a cotton swab. Wipe gently in a circular motion while chamber is warm.

Choose a Setting

Each heat setting offers a different experience. We suggest experimenting to find which settings work best for you and your consumption preferences.



Peak [Power] - 585°F

Delivering the most vapor and strength with less flavor.



High [Strong] - 540°F

Higher vapor production while maintaining flavor quality.



Med [Balanced] - 520°F

The best of both worlds. Balanced flavor and vapor.



Low [Flavor] - 500°F

Best for delicate extracts. Optimal flavor, least vapor.

3D Chamber + Mouthpiece



Detach quick-release 3D Chamber + Mouthpiece from Base.

Submerge the chamber in 90%+ isopropyl alcohol for 20 minutes. Turn upside down and let air-dry completely before reattaching.

Do not rinse with water.



Allow chamber to cool completely before handling.



Isopropyl alcohol is highly flammable; allow chamber to air-dry completely before reattaching.

Base



Detach quick-release 3D Chamber + Mouthpiece from Base.

Use a cotton swab soaked in 90%+ iso to gently clean the thread block.

Allow to air-dry completely before reattaching components.

DO NOT rinse or submerge in liquid.

How to Remove/Reinsert the 3D Chamber

Remove 3D Chamber from Pivot Mouthpiece by opening the top and gently pushing the metal chamber up from the bottom with a soft tool, like the silicone end of a Hot Knife. Do not use a sharp or metal object as this may damage the chamber.

Boost Mode

Increases the time and temperature of your hit by 15 seconds and 18° F. To activate: double-click to initiate heat cycle, then double-click again once desired temperature is reached.

Battery Life

Triple-click the button to check your battery level.

Green (Full)

Orange (Half)

Red (Low)



Visit Puffco.com/support
for how-to videos and helpful tips.

Please do not return your Pivot to the store.
Keep your proof of purchase.

@Puffco

Error Codes

No chamber (white white white white)

Remove and reinsert chamber.

Chamber error (red white red white)

Remove and clean chamber before reinserting.

Device overheating (red for 5 seconds)

Allow device to cool before using.

Low battery (red red red)

Ensure device is fully charged before using.

General Warnings

Do not overfill the chamber.

Do not blow or exhale into the mouthpiece.

Do not initiate heat up more than four (4) times consecutively.

Hold upright and inhale gently.

Strong inhales may cause spillage and suboptimal vapor.

Do not charge or operate in temperatures beyond 32°F – 100°F

Use only with provided USB-C cable.

Keep away from moisture and high humidity.

Store in a cool, dark place when not in use.

Chamber becomes hot while in use; use caution when handling.

**Not for use with tobacco, nicotine containing e-liquids,
or any synthetic nicotine or nicotine substitute.**

This appliance is not intended for use by persons (including children) with reduced physical, sensory, or mental capabilities, or lack of experience and knowledge, unless they have been given supervision or instruction concerning use of the appliance by a person responsible for their safety.

Children should be supervised to ensure that they do not play with the appliance.

This appliance must only be supplied at safety extra low voltage corresponding to the marking on the appliance.

If charger is used for charging purpose, only the certified charger that comply with IEC/EN 60335 or IEC/EN 61558 can be used.

WARNING: Use only an external supply with the following specifications: <5V > <1A>

The normal temperature range for charging the battery:
32 F – 100 F

The battery type: Rechargeable Li-ion Battery

Dispose of batteries according to your local environmental laws and guidelines.

The lithium-ion battery in the device should be serviced or recycled by an authorized service provider and disposed of separately from household waste.

Do not handle a damaged or leaking battery. Do not let leaking battery fluid come in contact with your eyes skin or clothing.

Do not expose the device or battery to excessive temperatures.

Be aware of the risk of terminals of the battery-operated device or battery being short circuited by metal objects.

This appliance contains batteries that are non-replaceable.

This appliance contains batteries that are only replaceable by skilled persons.

When the battery is at end of life, the appliance shall be properly disposed of.